

EXPRESS HIGHWAY →

SECTION A-A

M/S. E.D. HARRY & CO. LTD.

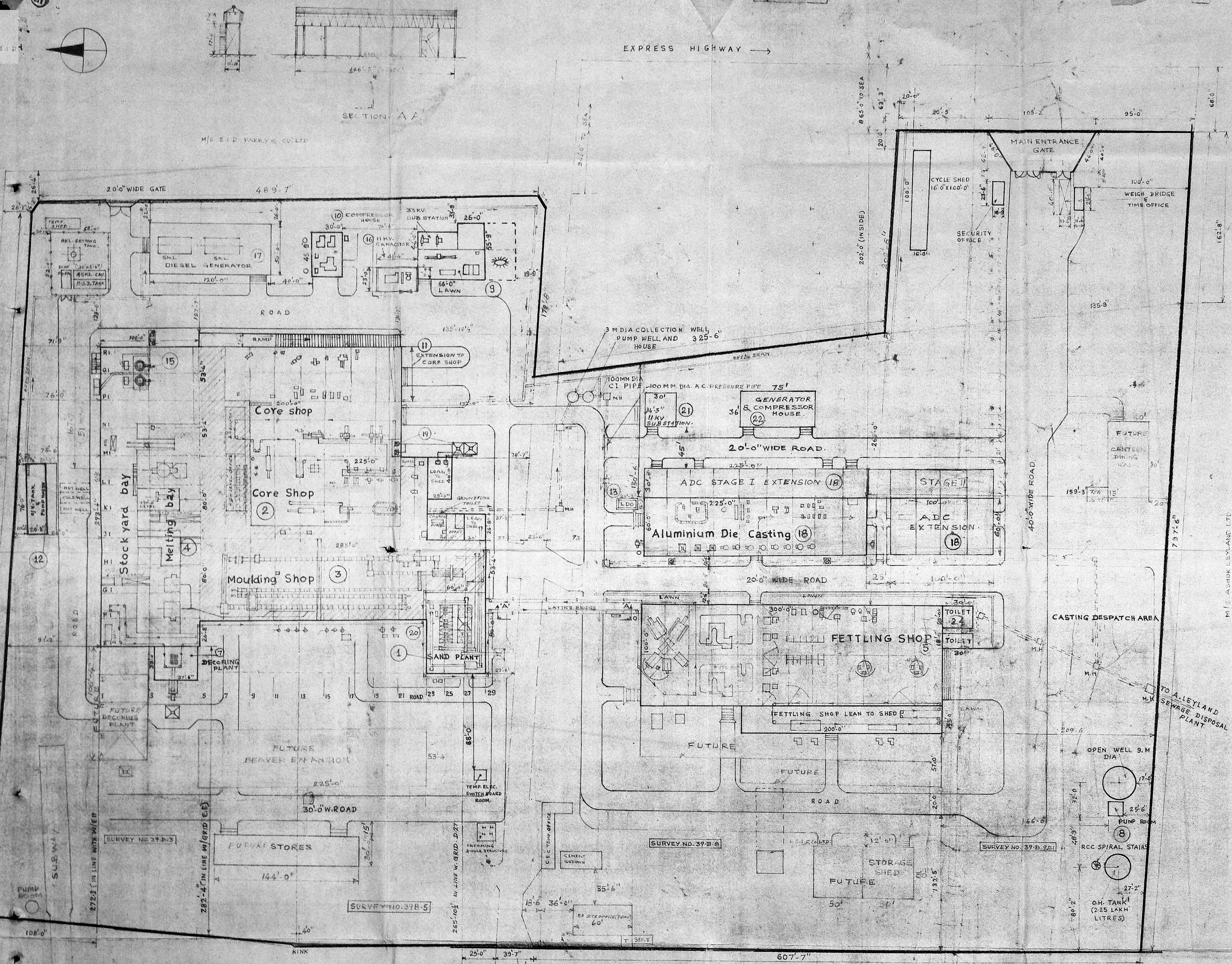

SNO	DESCRIPTION	DRG. NO.	M.M.D.A. APPROVAL	KATHIRWAKKAM TOWNSHIP APPROVAL	CHIEF INSPECTOR OF FACTORIES APPROVAL	H.P./KVA
1	SAND PLANT	PEP 016	DO	DO	DO	531.5 HP
2	CORE SHOP	PEP 035	DO	DO	DO	543.5 HP
3	MOULDING SHOP	PEP 101	DO	DO	DO	536.0 HP
4	MELTING SHOP	PEP 052	DO	DO	DO	541.5 + 620 HP
5	FETTLING SHOP	PEP 051	DO	DO	DO	407.5 HP
7	DECORING	PEP 304	DO	DO	DO	145.0 HP
8	PUMP HOUSE (SOUTH)		DO	DO	DO	20 HP
9	33 KV SUB STATION	PEP 372	DO	DO	DO	695.5 HP
10	COMPRESSOR HOUSE	PEP 007	DO	DO	DO	137.0 HP
11	EXTENSION TO CORE SHOP	PEP 007	DO	DO	DO	10 HP
12	UNDERGROUND PUMP HOUSE	PEP 007	DO	DO	DO	265 HP
13	L.D.O. TANK	PEP 007	DO	DO	DO	
14	LIGHTING AND A.C.	PEP 007	DO	DO	DO	
15	CUPOLA INSTALLATION					
16	11KV CAPACITOR INSTALLATION					
17	1150KVA/11KV DIESEL GENERATOR HOUSE					
18	ALUMINIUM DIE CASTING EXTENSION	PEP 674				316.0 HP + 664 KW
19	SAND DISTRIBUTION SYSTEM FOR STORAGE HOPPERS AND MINI HIGH SPEED CONTINUOUS MIXER					
20	NO.3 MILLOR AND STORAGE HOPPERS					
21	11KV SUB STATION					
22	GENERATOR & COMPRESSOR HOUSE					
23	SUBWAY PUMP ROOM					
24	TOILET & SAND DRIER	PEP 007				14.0 H.P.
TOTAL						

TOTAL APPROVED CONNECTED LOAD 3801.5 H.P. + 6200 KVA = 11173.5 H.P.
 TOTAL PROPOSED CONNECTED LOAD 3160 H.P. + 664 KW = 1201.33 HP
TOTAL = 12374.83 H.P.

- WORKING PLATFORM AT +11.0' LEVEL
- MEZZANINE FLOOR AT +14.0' LEVEL
- MEZZANINE FLOOR AT +10.0' LEVEL
- STEEL PLATFORM AT +14.0' LEVEL

KRAMAKRISHNAN B.E. MANAGER

- PROPOSED INSTALLATION
- EXISTING
- FUTURE
- BOUNDARY

REV	DESCRIPTION	DATE	SCALE
E	11KV SUB STATION GENERATOR & COMPRESSOR HOUSE, A.C. EXTENSION ADDED.	2-4-88	DKM
D	NO.3 SAND PLANT MILLOR AND STORAGE HOPPERS, CORE SAND DISTRIBUTION SYSTEM FOR STORAGE HOPPERS AND MINI HIGH SPEED CONTINUOUS MIXER.	10-2-88	DKM
C	GENERATOR HOUSE AND ALUMINIUM DIE CASTING EXTENSION ADDED.	24-3-88	DKM
B	11KV CAPACITOR INSTALLATION ADDED.	21-2-88	DKM
A	CUPOLA INSTALLATION DETAILS.	2-3-84	DKM

Planning Permit No. **SP/198/85**
APPROVED
 SUBJECT TO THE CONDITIONS IN THIS OFFICE LETTER.
 No. **14481/39** Date **2/11/88**
 For MEMBER SECRETARY
 MADRAS METROPOLITAN
 DEVELOPMENT AUTHORITY
 MADRAS - 600 038.

For ENNORE FOUNDRIES LTD.
 K. SHANMUGAM,
 General Manager,
 Projects & Plant Engg.

JINJOU RAO, I.C.E.
 Licensed Building Surveyor,
 Kathirwakkam, Madras-41 Township
 Madras-600 007.

20/6
 Survey sheet 1/2
 For ENNORE FOUNDRIES LTD.
 K. SHANMUGAM,
 General Manager,
 Projects & Plant Engg.

A
C2/14481/39
 DRG No. PFD 553

125 x 17.8 N

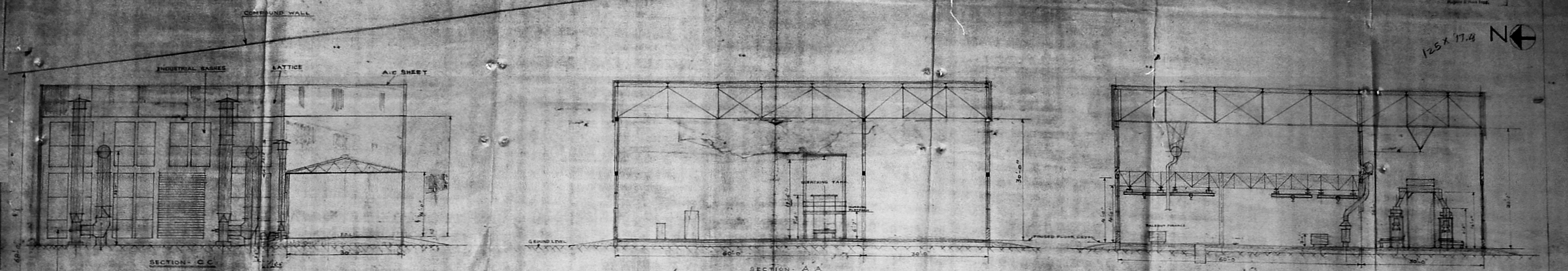

SCHEDULE OF JOINERY

R/S. STEEL ROLLING SHUTTER	12'0" x 15'0"
R/SL	8'0" x 15'0"
R/SS	12'0" x 15'0"
W/ STEEL CASERMENT WINDOW	5'2" x 3'8"
W/L	5'0" x 4'0"
W/L	5'0" x 4'0"
R/L R.C. LOUVER	5'2" x 13'2"

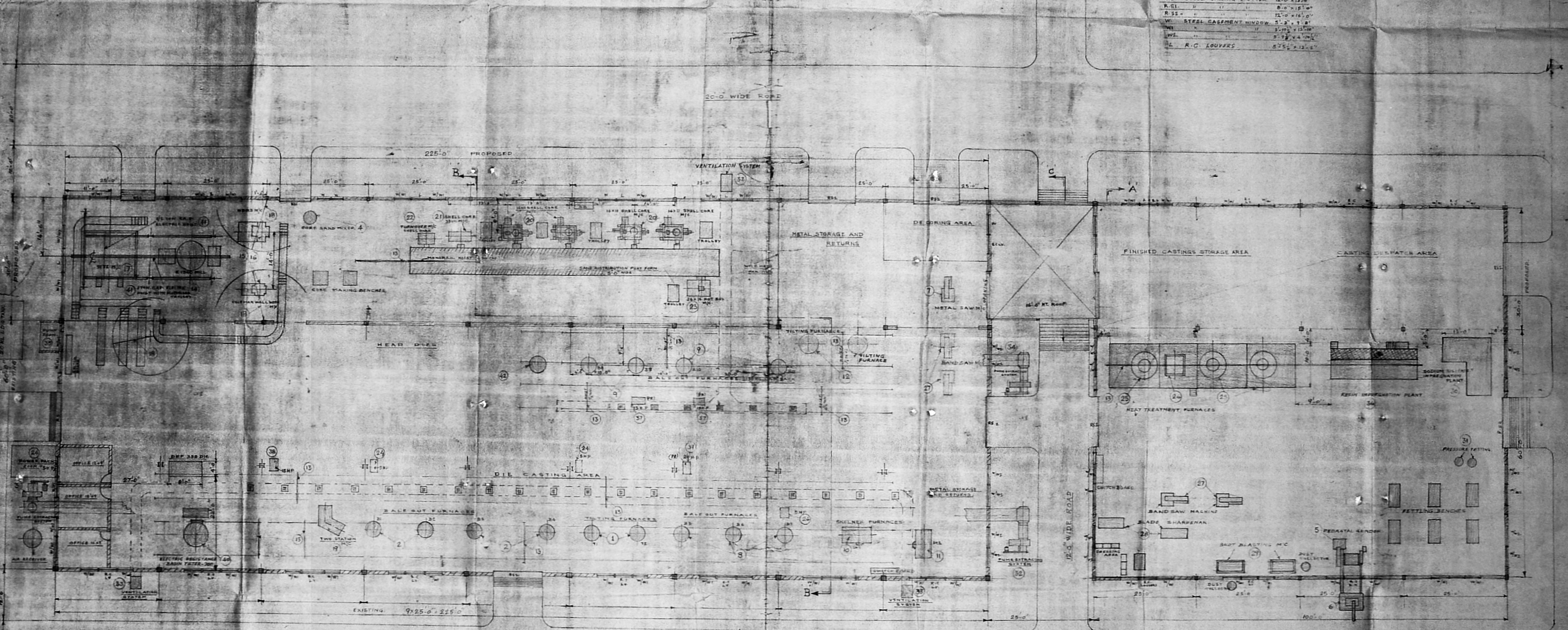

EXISTING			PROPOSED			TOTAL		
NO	DESCRIPTION	QTY	NO	DESCRIPTION	QTY	NO	DESCRIPTION	QTY
1	TILTING FURNACE	2	8	SALE OUT FURNACE (OIL FIRED)	3	23	HOT BOX M/C 26X16	1
2	SALE OUT FURNACE (OIL FIRED)	4	9	SALE OUT FURNACE (ELECTRICAL)	2	24	HYDRAULIC POWER PACK	4
3	FUME EXTRACTION	1	11	SPELNER FURNACE (OIL FIRED)	3	25	H.T. FURNACE	3
4	CORE SAND MIXER	1	12	SPELNER FURNACE (OIL FIRED)	3	26	QUENCHING TANK	1
5	DOBBLE END GRINDER	1	13	TILTING FURNACE (OIL FIRED)	3	27	BAND SAW	4
6	DUST COLLECTOR	1	14	AIR HOIST	0	28	BLADE BRAZING, STAGGERING & SHARPENING	2
7	METAL SAW	1	15	MOULDING SAND MIXER	30HP	29	SHOT BLASTING M/C	2
			16	MOULDING MACHINE	-	30	SODIUM SILICATE IMPREGINATION PLANT	1
			17	MOULDING M/C	-	31	PRESSURE TESTING UNIT	1
			18	TWO STATION MACHINE	-	32	FUME EXTRACTION UNIT	1
			19	TWO STATION MACHINE	-	33	UNDER GRAUND VENTILATION SYSTEM	3
			20	16X12 SHELL CORE MACHINE	4	34	FUME EXTRACTION UNIT	2
			21	15X11 SHELL CORE MACHINE	2	35	FURNACE OIL PUMPS	2
			22	12X10 SHELL CORE MACHINE (T/O)	1	36	RESIN IMPREGINATION PLANT	1

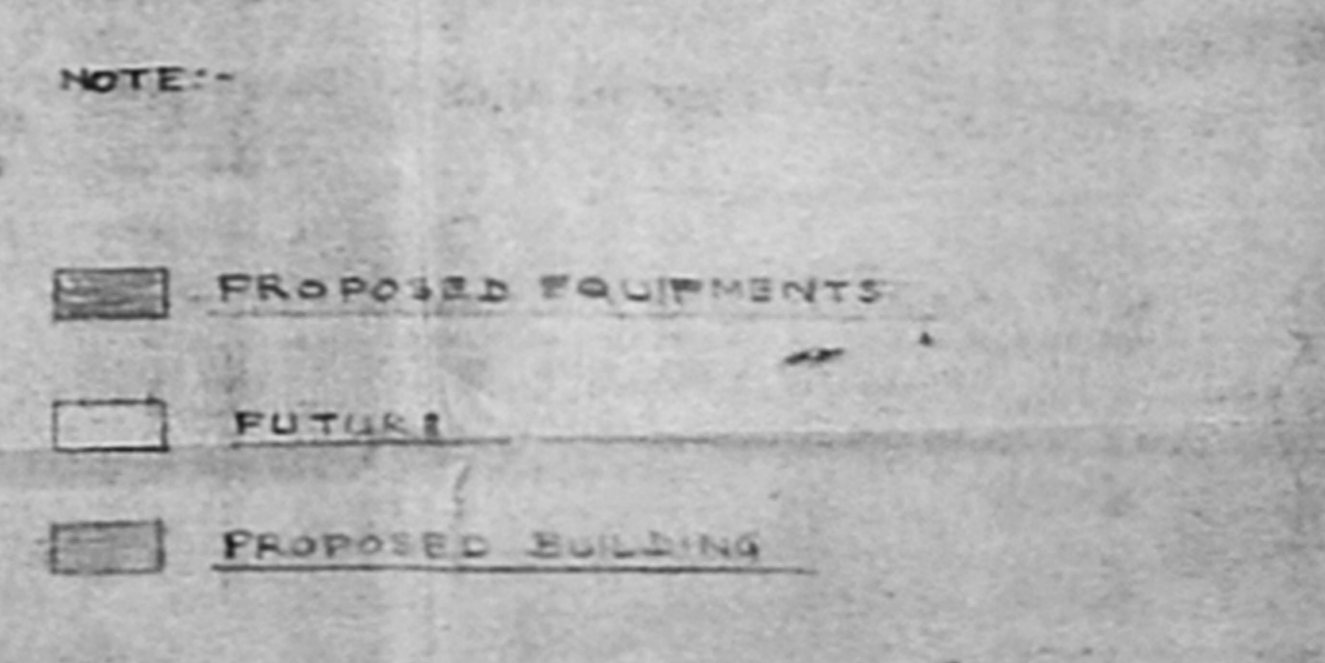

ALUMINIUM DIE CASTING MODERNISATION LAYOUT - EAST END

APPROVE

FOR ENNOSE FOUNDRIES LTD.

FOR MEMBER SECRETARY

INDIA

ENNOSE FOUNDRIES LTD.

ENNOSE MADRAS

INDIA

INDIA

INDIA

INDIA